

Arc Big tent Technical Data

弧形大帐篷技术参数



Item 名称	Specification 规格
Clear-span width 篷房跨度	15m/20m/25m/30m
Eave height 屋檐高度	3.88m/3.88m/3.88m/3.92m
Ridge height 屋脊高度	5.73m/6.53m/7.33m/7.87m
Roof pitch 屋面坡度	18°
Bay distance 单元间距	5m
Longest component 最长部件	9.2m
Minimum tent length 最少起订	30m
Roof fixing 屋面固定	No limit 没有限制
Roof fixing 屋面固定	Bar tensioning
Main profile 主型材	203x110x4.5mm 254x120x5.0mm
Max. allowed wind speed 最高承受抗风	100km/hour 0.5kn/m ²
Eave/Ridge connection 屋檐/屋脊连接角	Hot-dip Galvanized steel insert 镀锌钢铁
Framework material 框架材料	Hard pressed extruded Aluminium 6061-T6 硬挤压铝合金 6061-T6 (13HW)
Cover material 篷面材料	Waterproof, fireproof (DIN4012 B1, M2), UV resistant 700-900g/m ² 防腐、防霉、抗紫外线、阻燃 (M2和B1) 等性能达到国际标准

Optional accessories

PVC window sidewalls	Hard walling system
Anchoring	Glass walling system
Rain Gutter	Transparent PVC cover and sidewall
Lining and curtain	Flooring system
Glass door units	Weight plate

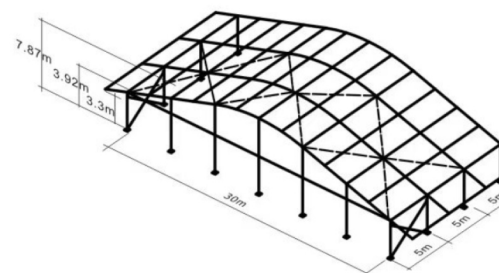
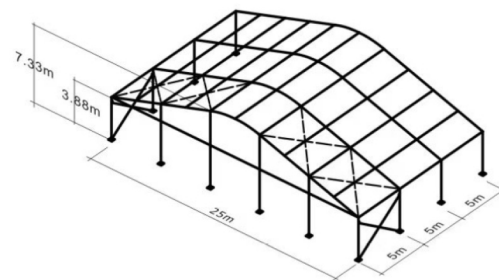
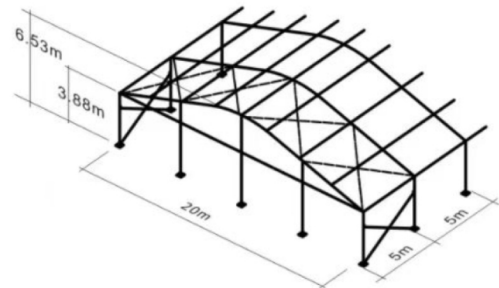
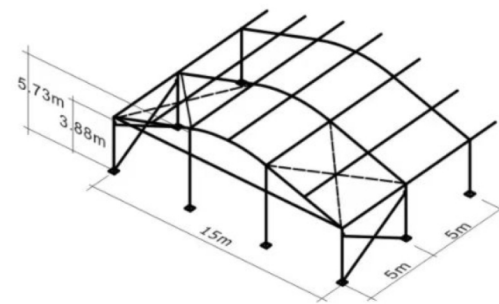

Arc Big tent Technical Data

弧形大帐篷技术参数

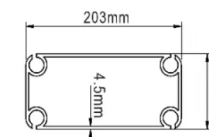
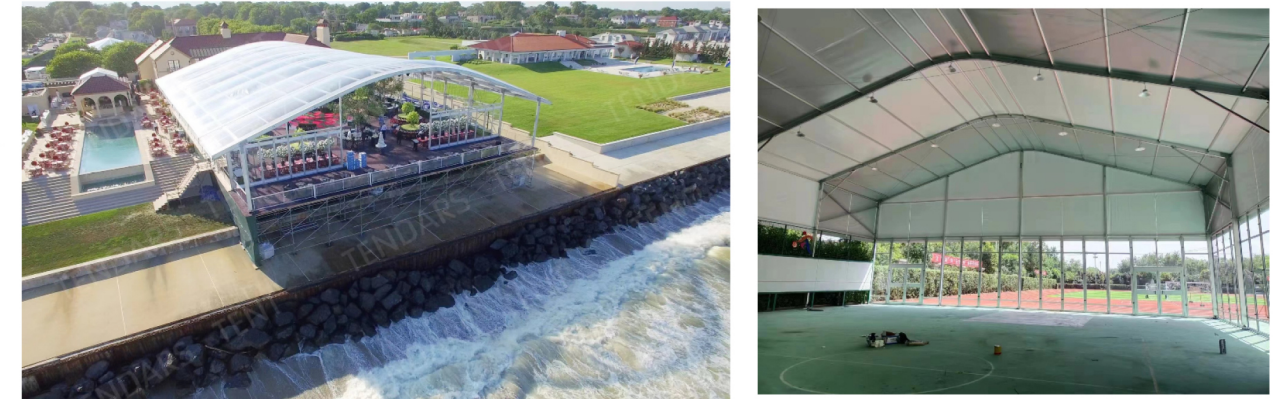

Gable pole
端面柱子

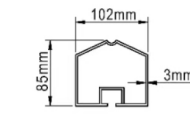

Eave Purlin, Gable pole, Ridge Purlin
屋檐梁、端面柱子、屋脊梁

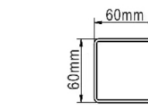

Intermediate Purlin
屋面方管

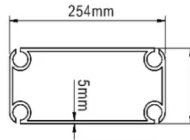

Gable pole
端面柱子

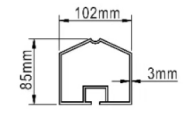

Eave Purlin, Gable pole, Ridge Purlin
屋檐梁、端面柱子、屋脊梁

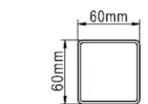

Intermediate Purlin
屋面方管

Optional accessories

PVC window sidewalls	PVC侧边围布
Glass door units	玻璃门
Anchoring	膨胀螺丝
Transparent PVC cover and sidewall	透明PVC墙和墙壁
Rain Gutter	雨水槽
Flooring system	地台
Lining and curtain	窗帘和围幔
Weight plate	称重盘

